









Welcome to the University of Nottingham Libraries

Helen Antcliff, Janis Hopkins, Joanne Downie



UoN Libraries

University Park Campus/KMC		
Hallward Library	Arts Humanities Social Sciences	
George Green Library	Engineering and Science resources	
Greenfield Medical Library	Medicine and Health Sciences	
Denis Arnold Music Library	Music	
Manuscripts and Special Collections	Manuscript and archive collections	

Jubilee Campus		
Djanolgy Learning Resource Centre	Education and computer science	
Business Library	Business, Commerce, Economics and Finance	

Sutton Bonington Campus		
James Cameron Gifford Library	Veterinary Medicine and Biosciences	

International Campuses		
China		
Malaysia		



Study Spaces

Highest daily footfall is usually in
Mid-May

Pre Covid

20,215

Peak visitors in one day
across all libraries.

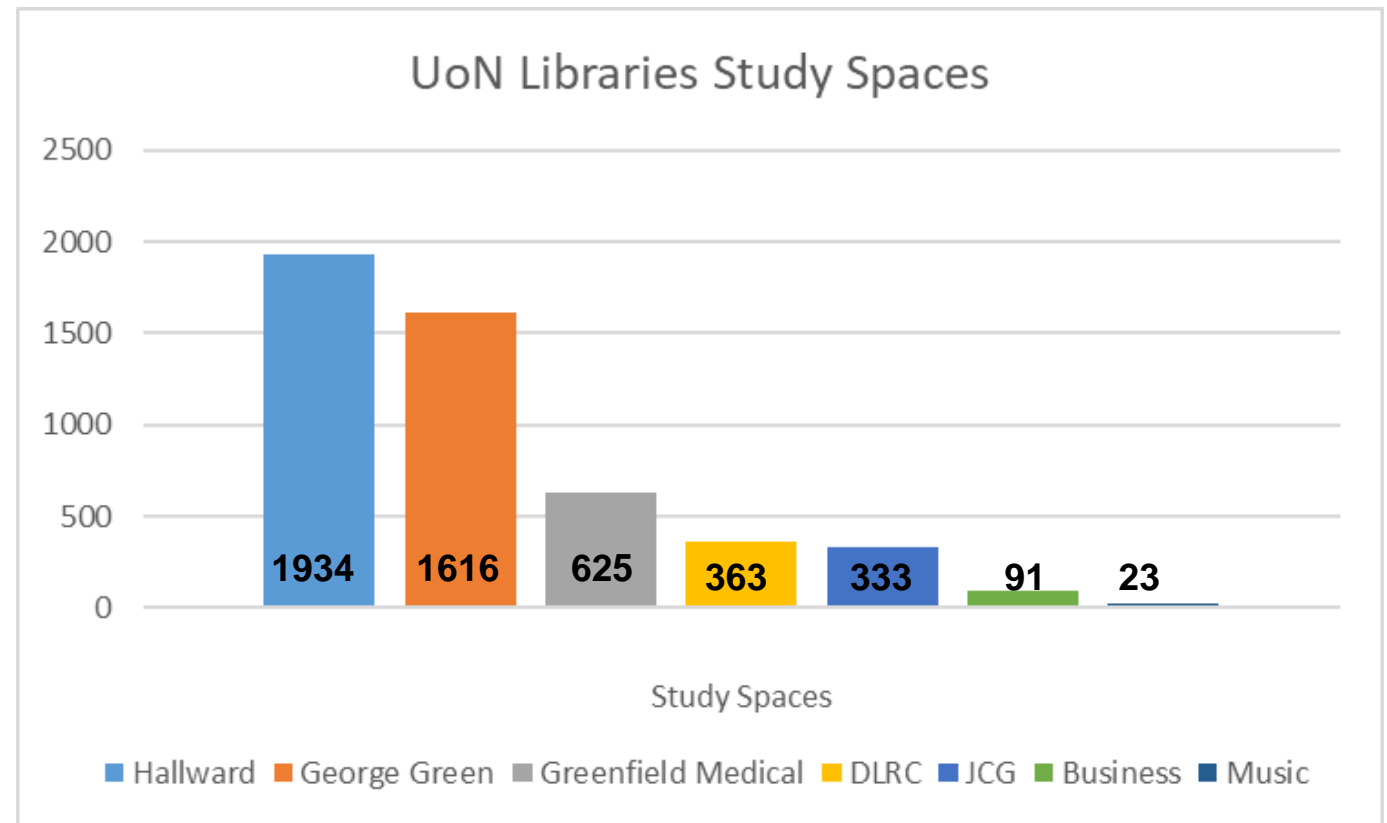



Hallward Library

Hallward Library

- One of the largest libraries housing over 1900 study spaces
- Arts and Social Sciences
- Houses European Documentation Centre
- Various bookable rooms and spaces including group and individual study.
- Enhanced Library Support Spaces and Assisive Technology Room





Denis Arnold Music Library



Denis Arnold Music Library

- Smallest UoN library housing 24 study spaces
- Supports the Faculty of Music
- Recording equipment available to loan
- Click and Collect
- Print, Copy , Scan





Greenfield Medical Library

Greenfield Medical Library

- Supports the faculty of Medicine & Health Sciences
- Based within Queens' Medical Centre hospital
- 625 study spaces
- ILL's Hub for Medicine and Science
- Supports NUH Staff - working in partnership with City hospital Library.
- No scrubs allowed !





James Cameron Gifford Library

James Cameron Gifford Library

- Veterinary and Bio Sciences Library based at Sutton Bonington Campus
- 333 study spaces
- UoN Library Helpline
- New ATR COMING SOON....
- Rural location with some friendly visitors!!

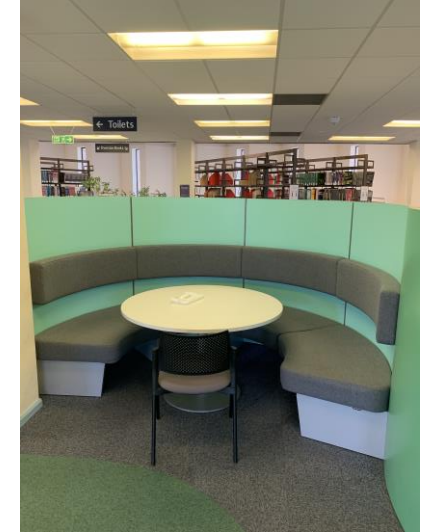



DLRC/Business

Business

- Located at the top of the Business School South on Jubilee Campus.
- Dedicated PCs for access to restricted databases.
- Collection exclusively Business related!



Djanogly Learning Resource Centre

- Positioned in the centre of the lake on Jubilee Campus
- Collection supports the Schools of Education and Computer Science.





George Green

George Green Library

- Science and Engineering Library
- Refurbished for c.£20 million about 5 years ago adding the 'petal' end to the South, an open, airy and very popular study space with its own challenges for managing noise.
- Postgraduate only floor
- Mix of individual and group study rooms

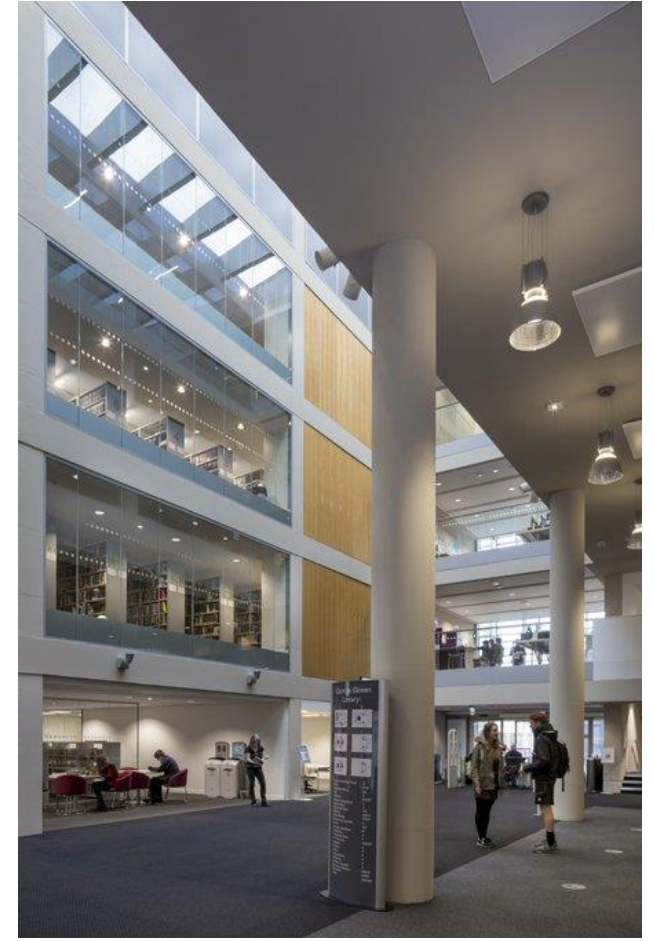



George Green

